

SOPHOS

Security made simple.

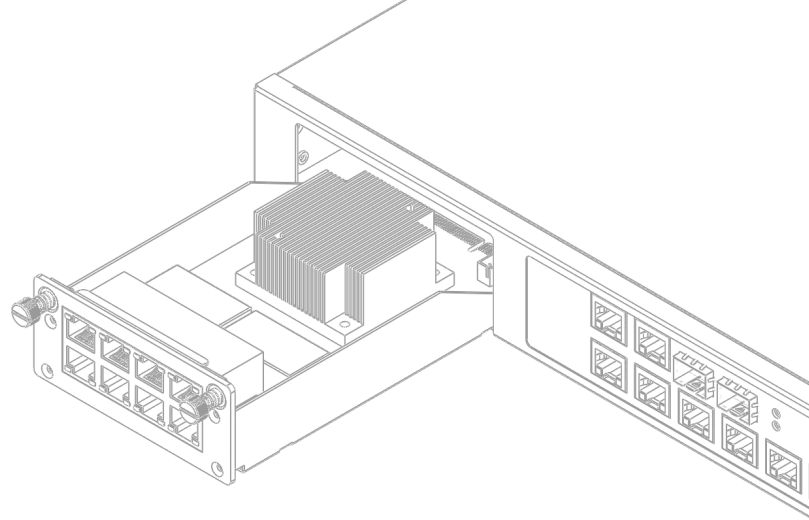

LAN Modules

Mounting Instructions

SG 210/230/310/330/430/450

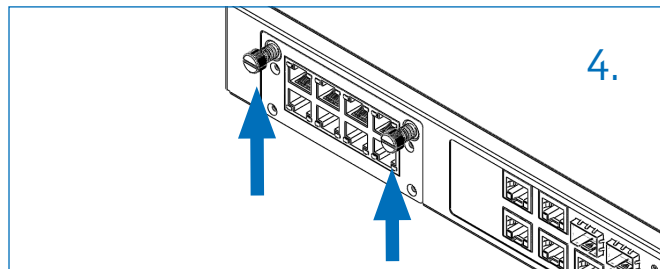
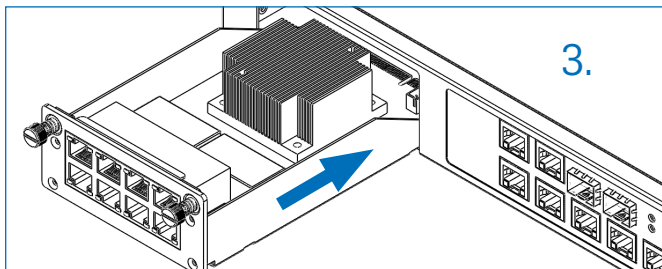
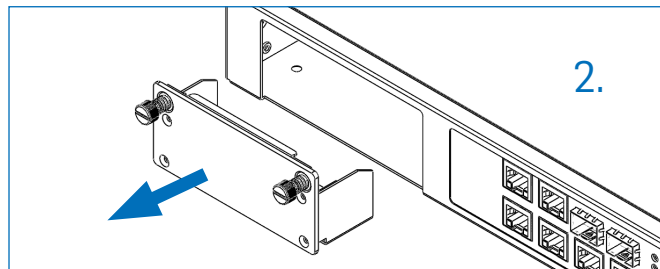
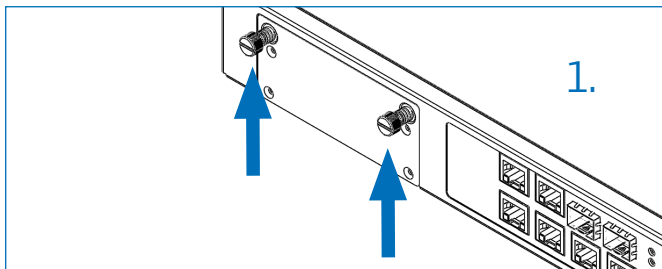

Before you begin please make sure that the appliance is turned off.

Notes for models SG 430/450

- ▶ You can use all modules that are available for these models in any slot
- ▶ However if you require throughput of more than 10 Gbps using 10 GbE modules we recommend using slots A or C

Mounting

1. Unscrew the metal plate from the vacant slot you want to use
2. Remove the metal plate
3. Insert the LAN module into the open slot
4. Tighten the screws of the LAN module

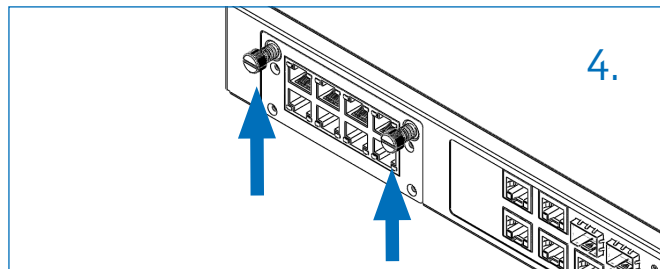
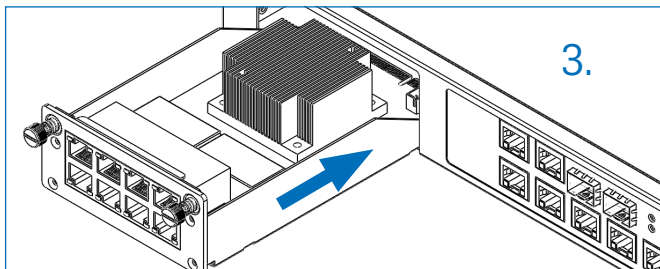
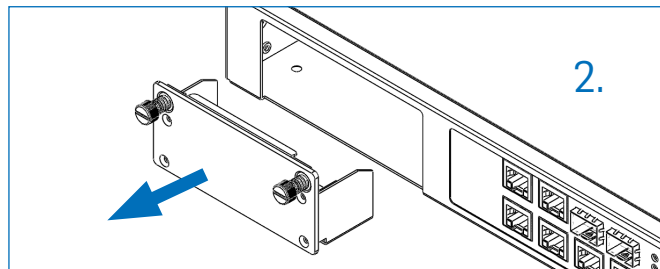
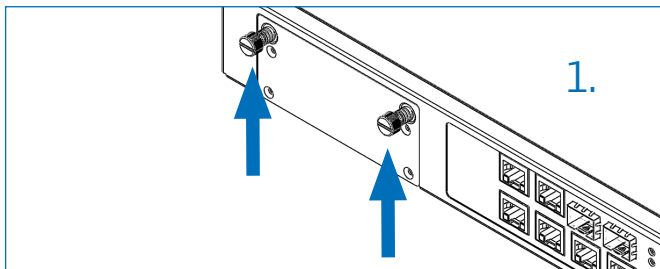

Bevor Sie beginnen, stellen Sie bitte sicher, dass die Appliance ausgeschaltet ist.

Hinweise zur den Modellen SG 430/450

- Sie können sämtliche für diese Modelle verfügbaren Module in jedem beliebigen Einschub verwenden
- Haben Sie jedoch Durchsatzanforderungen von mehr als 10 Gbps auf 10 GbE-Modulen so empfehlen wir hierfür die Verwendung der Einschübe A oder C

Befestigung

1. Lösen Sie die Schrauben des freien Einschubes, den Sie verwenden möchten
2. Entfernen Sie die Metallplatte
3. Schieben Sie das LAN Modul **ein** in die Öffnung
4. Ziehen Sie die Schrauben des LAN Moduls fest

SG 210/230/310/330/430/450 LAN Modules Mounting Instructions

Sales DACH
Deutschland, Österreich,
Schweiz
Tel: +49 (0) 611 5858-0
Tel: +49 (0)721 255 16-0
E-Mail: sales@sophos.de

United Kingdom Sales:
Tel: +44 (0)8447 671131
Email: sales@sophos.com

North American Sales:
Toll Free: 1-866-866-2802
Email: nasales@sophos.com

Australia & New Zealand Sales
Tel: +61 2 9409 9100
Email: sales@sophos.com.au

Boston, USA | Oxford, UK

© Copyright 2014. Sophos Ltd. All rights reserved.

All trademarks are the property of their respective owners.

02.14v1.dNA

The logo for Sophos, consisting of the word "SOPHOS" in a bold, blue, sans-serif font.